

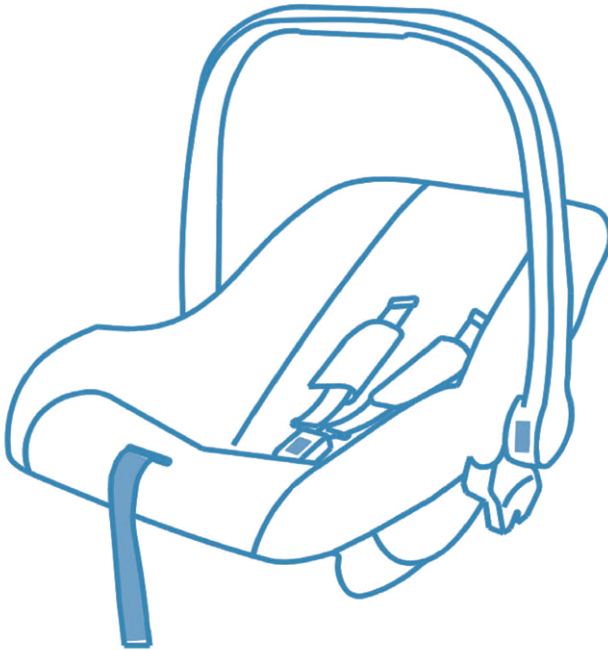

**xcursion**  
travel system  
**user guide**



**Group 0+with side protection**  
**Suitable from birth to 13kg**  
**From birth to approximately 12-15 months old.**

**IMPORTANT. KEEP FOR FUTURE REFERENCE**

# introduction

**IMPORTANT:** Read these instructions carefully before use and keep them for future reference. Your child's safety may be affected if you do not follow these instructions.

1. This is a "Universal" child restraint; it is approved to ECE Regulation 44.04 for general use in vehicles and will fit most, but not all, vehicle seats.
2. A correct fit is likely if the vehicle manufacturer has declared in the vehicle handbook that the vehicle is capable of accepting a "Universal" child restraint for this group.
3. This child restraint has been declared "Universal" under more stringent conditions than those applied to earlier designs which do not carry this notice.
4. If in doubt, consult either the child restraint manufacturer or the retailer.

The car safety seat must only be used in a forward facing seat fitted with 3-point static, 3-point retractor safety belts, approved to UN/ECE Regulation No. 16 or other equivalent standards.

## **EXTREME HAZARD DO NOT USE IN PASSENGER SEATS EQUIPPED WITH AIRBAGS (SRS)**

The correct use and maintenance of your car seat will ensure it gives long and trouble free use. When somebody else is using your car seat, ensure they also know how to use it, especially the correct way to adjust it. The safety of your child is your responsibility.

## safety warnings

1. PLEASE READ THOROUGHLY BEFORE COMMENCING INSTALLATION, AS AN INCORRECT INSTALLATION COULD BE DANGEROUS.
2. PARENTS SHOULD NOT UNDER ANY CIRCUMSTANCES USE THIS CHILD RESTRAINT ON A PASSENGER SEAT EQUIPPED WITH AN AIRBAG.
3. Make yourself familiar with these instructions and look carefully at the illustrations in this user guide.
4. The car safety seat offers maximum protection and is only safe when used in accordance with the instructions.
5. For the safety of your child it is of crucial importance that the car seatbelt is threaded correctly. Follow the blue routing labels on the front belt hooks and ensure that the shoulder belt is also secured behind the belt hook at the rear of the seat indicated by the blue routing label.
6. The car safety seat is approved in accordance with European safety standard (ECE R44/03) and is suitable for children from birth to 13kg (from birth to approximately 12-15 months old).
7. The car safety seat may be used on the front or rear passenger seat, but always in a rearward facing position. DO NOT use a child safety seat where the vehicle is equipped with a front airbag. This can be dangerous. This does not apply to so-called side airbags. When using the car safety seat on a collapsible rear seat, always check to make sure the rear seat is locked securely before installing the seat.
8. Never use the child seat without fastening the child's harness correctly, and never attempt to use it without fastening it into the car as described in these fitting instructions.
9. It is most important that the seat belt is correctly routed and the child seat tightened down on the upholstery as firmly as possible to ensure maximum protection - a recommended method is shown in these instructions.
10. Do not add to or modify this product in any way.
11. Never use this product if it has been in an accident, or if it has become badly worn. Periodically inspect the harness for wear, paying particular attention to attachment points, stitching and adjusting devices.
12. Do not leave a child in the seat unattended at any time.
13. We strongly advise you do not use a second-hand product, as you are never sure if the seat has been involved in an accident or whether it has been otherwise damaged.
14. Ensure that no part of the seat or seat belt is trapped in a door or a folding seat. If your car has a folding rear seat, ensure that it is correctly latched in its upright position.
15. Car interiors can become very hot when left standing in direct sunlight - it is therefore recommended that the child seat, when not in use, is covered by a towel etc. This prevents components, particularly those attached to the child seat, becoming hot and burning the child.
16. Luggage and other heavy objects should be secured in the car. Loose objects are liable to cause injury in the event of an accident.
17. The child seat must not be used without the cover.
18. Never place your child seat on a table or work surface.
19. This seat can be used for children of 0-13kg in weight (approximately birth to 13/15 months of age) and is used in conjunction with a 3-point lap and diagonal safety belt in the rear-facing position only.
20. When the child seat is not in use, it is recommended that it is fastened into the car with a seat belt to avoid it being thrown about in the event of an accident.
21. In an emergency your child can be released quickly by pressing the red button on the harness buckle.
22. Store this child seat in a safe place when it is not being used. Avoid placing heavy objects on top of it.
23. If you travel with passengers using both the front and rear passenger seats, the lighter occupants should be in the rear and the heavier occupants in the front of the vehicle.
24. Do not allow your child seat to come into contact with corrosive substances e.g. battery acid.

## getting to know your car seat

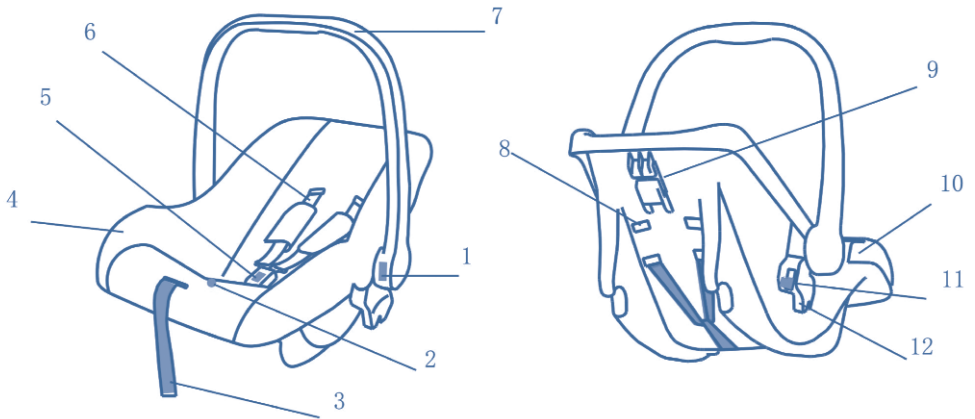

1. Red Button Handle Adjuster
2. Harness Adjuster under "Press"
3. Harness Adjuster Strap
4. Cover
5. Harness Buckle
6. Shoulder Straps
7. Carry Handle
8. Shoulder Harness Slots
9. Dark Blue Diagonal Belt Guide
10. Light Blue Lap Belt Guide
11. Red switch
12. Coupler

# in use

## the harness

fig 1

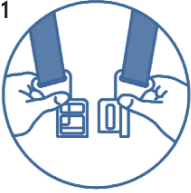

Slot the two plastic sections of the buckle connectors together.

fig 2

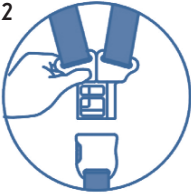

Slot the two connectors into the hole in the top of the buckle until they "click" into place.

fig 3



Always check that the harness is correctly locked by pulling above and below the buckle.

fig 4



The harness should be adjusted as tightly as possible without causing discomfort to the child. To tighten harness, pull down on adjustment strap.

fig 5



The harness is loosened by pulling on both straps at the same time press down on the harness adjuster that is located on the shell underneath the "Press" word stitched on the cover.

## unfastening the harness

To release the harness, push the red button in the middle of the harness buckle inwards. You can now lift your child from the seat; ensure that the buckle connectors do not catch on clothing.

## adjusting the shoulder height

fig 6



too low



too high



correct

The harness has 2 positions. The straps should go into the slots at, or the nearest slots above the height of the child's shoulders. To adjust the harness, remove each strap by passing it through the slots from the front to the back of the seat; re-route the straps through the appropriate slots.

## fitting your car seat into the car

fig 7

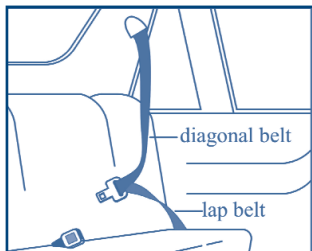

**WARNING:** This car seat can only be fitted into the passenger seat of a car with a lap and diagonal seat belt and no air bag.

**THE TYPE OF APPROVED SEAT BELT YOU MUST HAVE**  
Your child seat can only be installed rearward facing using a lap and diagonal seat belt in the front or rear passenger seat of the car.

# in use

## installation

fig 8



Push the child seat facing rearward firmly against the backrest of the car's seat.

fig 9

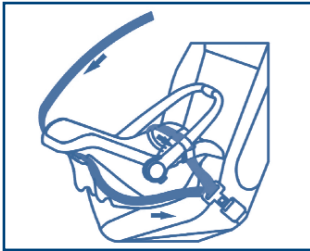

Route the lap section of the adult safety belt through the lap belt guides, (indicated by the blue markers) and fasten the car seat belt.

fig 10



Place the diagonal belt in the diagonal seat belt guide, (indicated by the blue markers) at the back of the seat.

fig 11



Take out all the slack in the seat belt, ensuring that there are no twists or kinks in the seat belt.

## checklist

However safe a child seat is, however well built it is, your child's safety depends on you. Read this final checklist once you have fitted your child seat in your car.

1. Check that you have adjusted the harness to suit your child. A fitting for winter clothes will be too loose for a child wearing summer clothes.
2. Check you have installed your child seat properly using a 3 point lap - see above installation.
3. Check that your child seat is secure before each journey.
4. Make sure that there are no kinks or twists in the car seat belt.  
REMEMBER; Misusing your child seat will reduce the protection and safety you offer your child.

## adjusting the handle

To adjust the handle from one position to another, pull out both sides of the handle on the swivel point; rotate the handle forwards or backwards into the desired position:

fig 12



Forward in the car.

fig 13

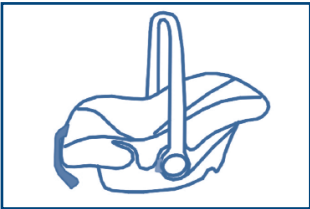

Straight up for carrying.

fig 14

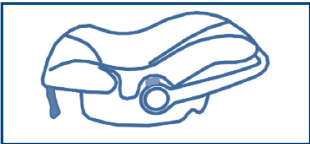

Against the car seat for rocking.

fig 15

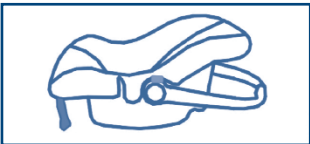

All the way down to support baby for feeding and play.

fig 16

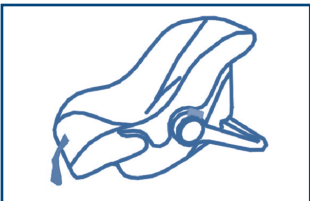

Stop rocking.

**Always ensure that the handle is locked in position and that the harness is correctly fitted and the buckle fastened before lifting your car seat.**



## canopy assembly

fig 17

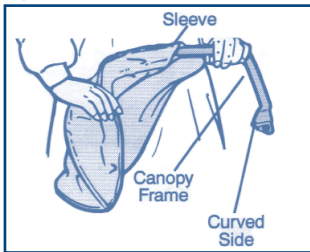

Insert frame through sleeve of canopy.

**NOTE:** Curved side of canopy frame must point towards canopy material.

fig 18

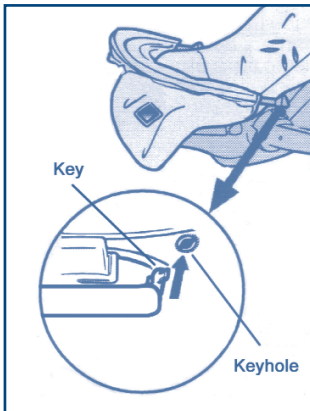

Insert keys on both ends of canopy frame into keyholes on car seat casting located above handle hubs.

Rotate canopy frame back.

**HINT:** It may be helpful to detach side of seat pad to see keyholes.

## installation onto the xcursion pushchair to make a travel system

fig 19

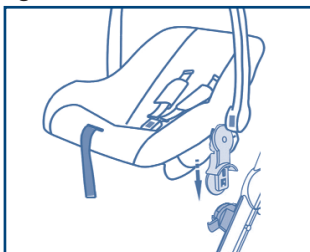

Attach the car seat unit to the chassis as shown. Can be attached front or rear facing. Please ensure that the seat unit is securely attached to the frame before use.

## in use

fig 20

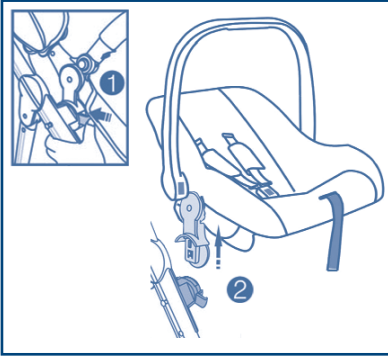

Push the buttons inwards as shown on each side and lift the car seat away from the frame.

## care of your product

### removing the cover

The fabric cover can be easily removed for washing. Remove the harness by gently feeding the harness straps through from the front to the back of the seat, the crotch strap including the buckle should be removed; turn the metal slide underneath the shell on its side and feed it through the shell until the strap is free. Remove the cover and machine wash at 30 , line dry only.

To replace the fabric cover, follow reverse of the above.

### cleaning the seat

The harness and plastic parts can be sponged with very mild detergent and warm water. Do not use chemical cleansers, bleach or corrosives on any part of the seat.



# your child's safety is your responsibility

If you have a problem with this product or require any replacement parts, please contact your nearest Mothercare store or telephone the Mothercare Customer Care Line on 08453 30 40 30

alternatively write to:

Customer care  
Mothercare  
Cherry Tree Road  
Watford  
Herts. WD24 6SH

[www.mothercare.com](http://www.mothercare.com)

Made in China